

MICROFILM

- STYLES -

N 8-11 W →

200.0

PARIS VIEW DRIVE

- 46 -

- 47 -

- STYLES -

2.981 ← M.C.S. 18 S

188.0 ← N 81-57 E

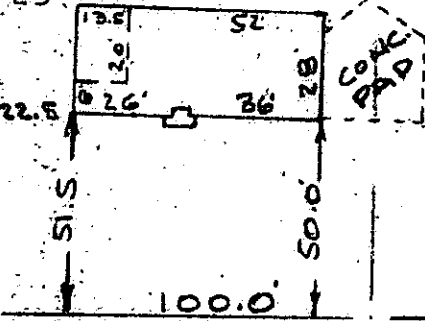

GREENVILLE
 JUL 28 3:47 PM '80
 DONNIE E. TAMMERSLE
 R.M.C.

TUBBS MOUNTAIN RD

WATER & SEWER IN ST R/W

PROPERTY OF

BILLY JOE HESTER

TRAVELERS REST GREENVILLE COUNTY, S.C.

SCALE 1" = 50'

28 JULY 1980

This is to certify that on the 28th day of July, 1980, I surveyed the property shown on this plat, being known as lot 47, and a unnumbered lot on plat of PROPERTY OF HOMER STYLES and recorded in the RMC Office Greenville County, S. C., in Plat Book "YY" at Page 101 and also being known as PROPERTY OF BILLY JOE HESTER and recorded in Plat Book _____ at Page _____; and that the property lines, walls and buildings are as shown hereon, and that the walls and buildings located on said lot do not encroach or project on adjacent street or property, and that no adjacent walls or buildings encroach or project on said premises, and no power lines cross this property except as shown hereon.

R. B. Bruce

2658

R. B. Bruce, R.L.S. 8/1958

8-C-72

JUL 29 1980

CAROLINA SURVEYING CO.
 112 Manly St.
 Greenville, S. C.

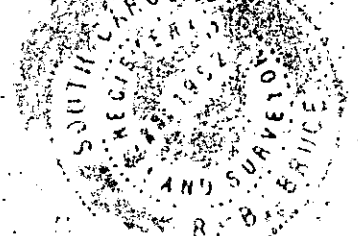

3 JUL 29 80 1167

3.00CT

225/47

CO 31 1 13 1 2 7 5